

## Assembling - Maintenance

This drawing is appendix A of the installation and maintenance instruction "Pressure release valve 3/8" ".  
The complete installation and maintenance instruction is hosted at [www.allfi.com](http://www.allfi.com)

- Pneumatic cylinder **must not** be pressurized during assembly & disassembly
- Function test with several open and closed cycles
- After finishing maintenance flush the valve at < 500 bar / 7,200 psi
- Pressure relief holes must not be covered or closed

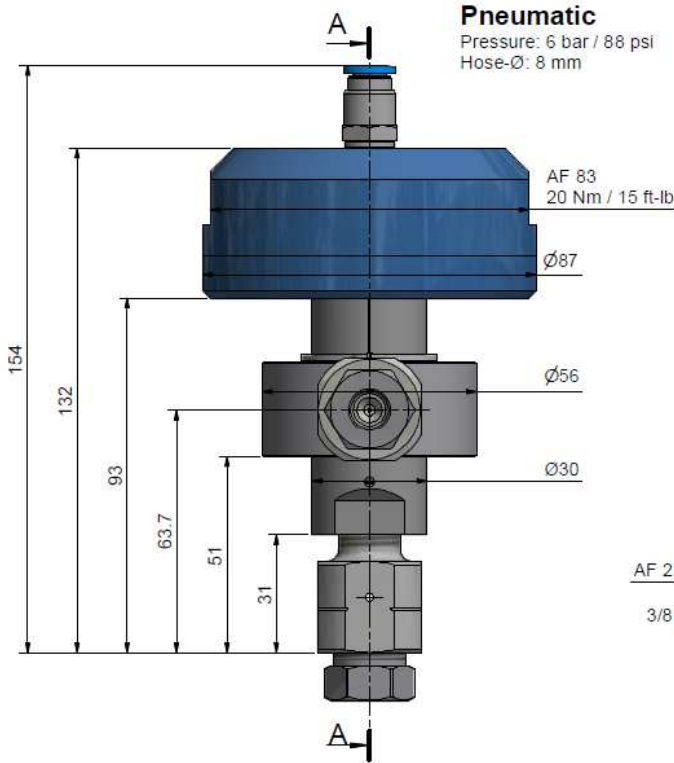
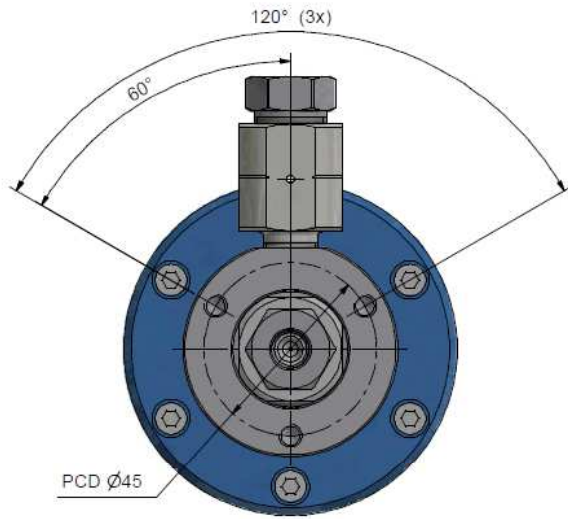

**Pneumatic**  
Pressure: 6 bar / 88 psi  
Hose-Ø: 8 mm

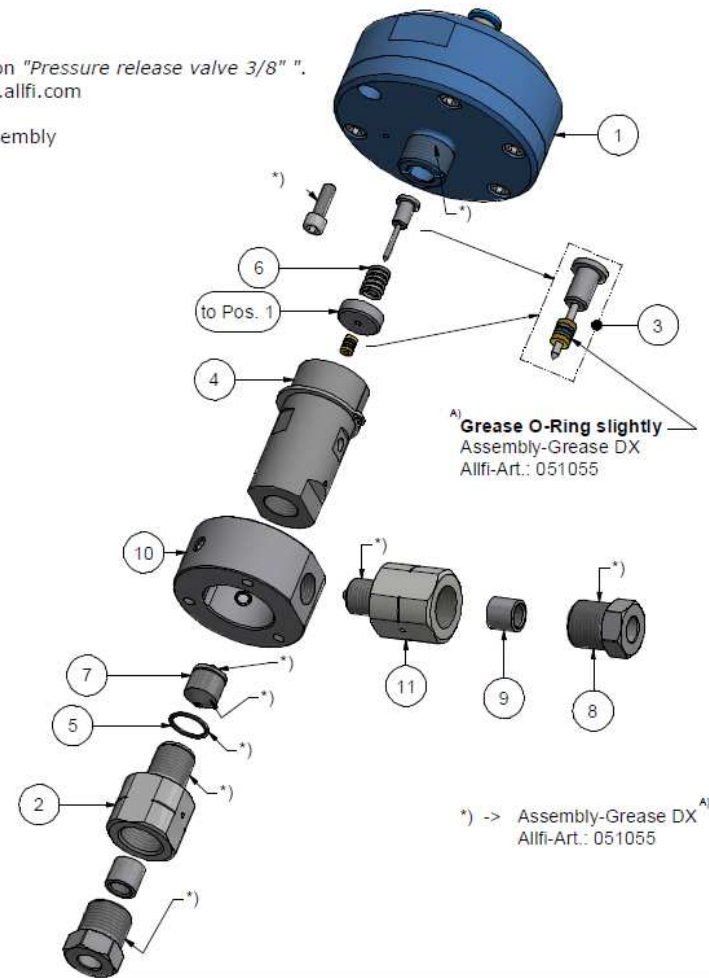
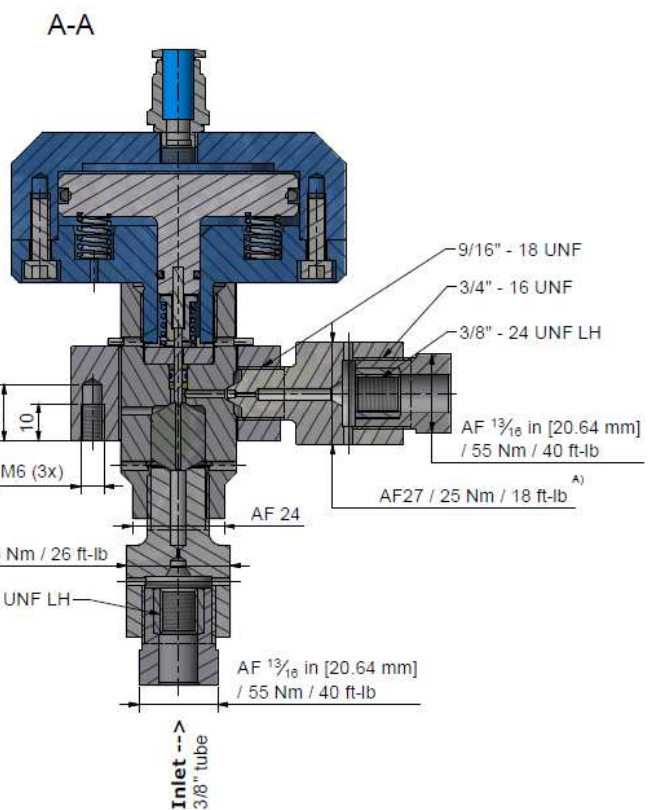

Item	Qty	Description	Part-Number	Comments	Weight
1	1	Pneumatic Cylinder	919090		560.3 g
2	1	Restrictor to Valve Seat Imp	901260-I	Wear part	120.2 g
3	1	Seal kit	901431	Wear part	3.6 g
4	1	Valve case	900610	Wear part	245.8 g
5	1	O-Ring D=14 x 1.5	010013		0.1 g
6	1	Compression Spring	021006		1.4 g
7	1	Valve Seat	900014	Wear part	17.2 g
8	2	Gland Nut 3/8" Imp	703807		40.8 g
9	2	Collar 3/8"	713800		6.8 g
10	1	Coupling Ring 1/4" Imp	900074-I		309.1 g
11	1	Restrict m/f 1/4" - 3/8" Imp	661438-I	Wear part	129.6 g

General tolerances ISO 2768-1 m

Amendment:  
A) Beschäftigung & Fertigungsdienste, 21.02.2018 AM  
B) 0058, Drehmoment angepasst, 17.02.2020 AM

Replace for	-
Replaced by	-
Drawn	17.03.2017 AM
Checked	24.03.2017 BT
Release	24.03.2017 BT
Index-release	17.02.2020 RB

**Pressure relief valve 3/8" Imp** Scale 1 : 1

Max. 4150 bar / 60,000 psi Restrictor

**919110-I** Index B

ALLFI AG - RIEDENMATT 1 - CH-8370 STANS  
PHONE +41(0)41-818 05 05 - TELEFAX +41(0)41-818 05 10  
E-MAIL: [sales@allfi.com](mailto:sales@allfi.com) <http://www.allfi.com>