

## Assembling - Maintenance

This drawing is appendix A of the installation and maintenance instruction "Pressure release valve 1/4". The complete installation and maintenance instruction is hosted at [www.allfi.com](http://www.allfi.com)

- Pneumatic cylinder **must not** be pressurized during assembly & disassembly
- Function test with several open and closed cycles
- After finishing maintenance flush the valve at < 500 bar / 7'200 psi
- Pressure relief holes must not be covered or closed
- **ATTENTION: Don't pressurize the valve must be depressurized at the outlet and don't use it as On/Off Valve**

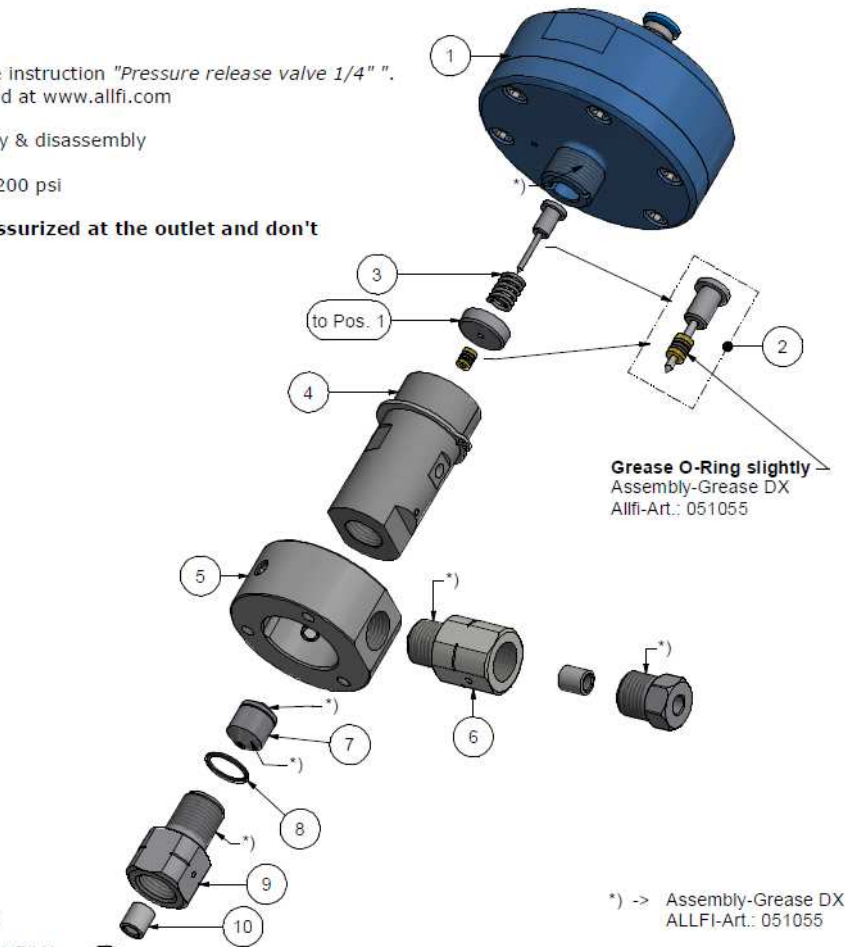
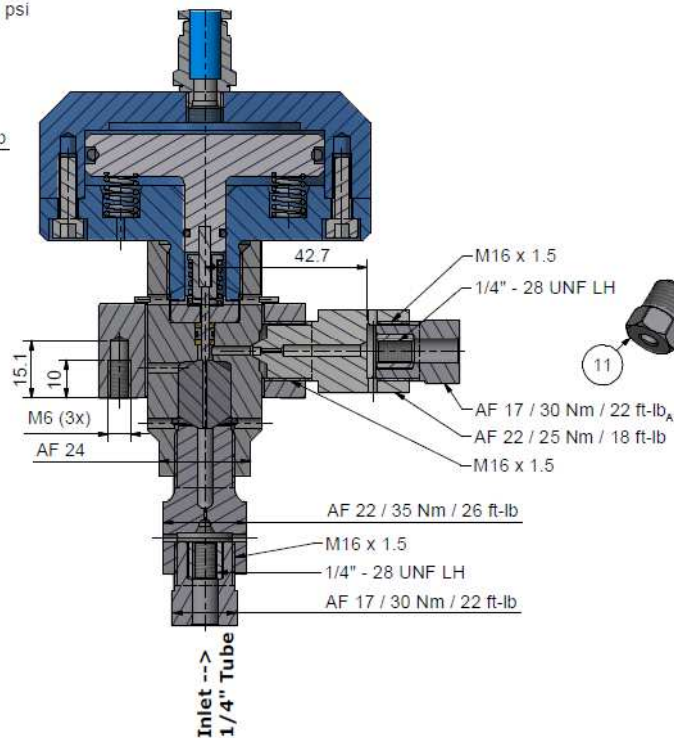
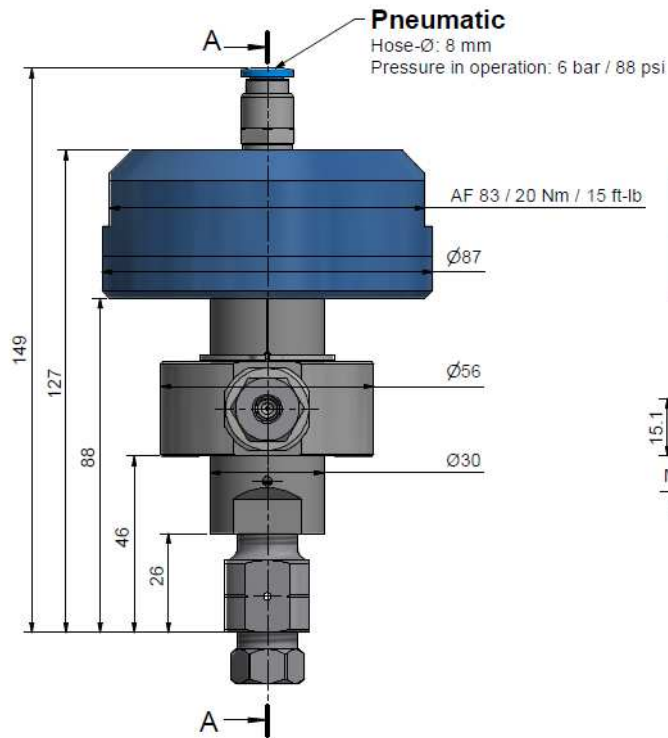

Item	Qty	Description	Part-Number	Comments	Weight
1	1	Pneumatic Cylinder	919090		580.3 g
2	1	Seal kit	901431	(2 Discs)	3.6 g
3	1	Compression Spring	021006		1.4 g
4	1	Valve case	900610	Wear part	245.8 g
5	1	Coupling Ring	900074		305.8 g
6	1	Restrictor m/f 1/4" - 1/4"	661414-P	Wear part	85.5 g
7	1	Valve Seat	900014	Wear part	17.2 g
8	1	O-Ring D=14 x 1.5	010013		0.1 g
9	1	Restrictor to Valve Seat 1/4"	901261-P	Wear part	79.8 g
10	2	Collar 1/4"	711403		3.1 g
11	2	Gland Nut 1/4"	701403		29.1 g

General tolerances ISO 2768-1 mK. Designs and drawings created and produced by the contractor are the contractor's intellectual property and may only be used for the purposes of the order.

Amendment:	Replace for	-
A) 0058, Drehmoment angepasst, 14.02.2020 AM	Replaced by	-
	Drawn	12.05.2017 AM
	Checked	01.07.2017 RB
	Release	25.08.2017 BT
	Index-release	24.02.2020 BT

Pressure relief valve 1/4"

Scale 1 : 1  
Max. 4150 bar / 60,000 psi  
With throttle



ALLFI AG - RIEDENMATT 1 - CH-8370 STANS  
PHONE +41(0)41-818 05 05  
E-MAIL: [sales@allfi.com](mailto:sales@allfi.com) <http://www.allfi.com>

919010	Index	Sheet	2
	A	No. of sheets	2