

Assembling - Maintenance

This drawing is appendix A of the installation and maintenance instruction "Hand valve 2.0".
 Complete installation and maintenance instruction refer to QR-Code or:
<https://www.allfi.com/en/services/downloads/product-manuals/>

- Pressure relief holes must not be covered or closed.



Detail B (3 : 2)

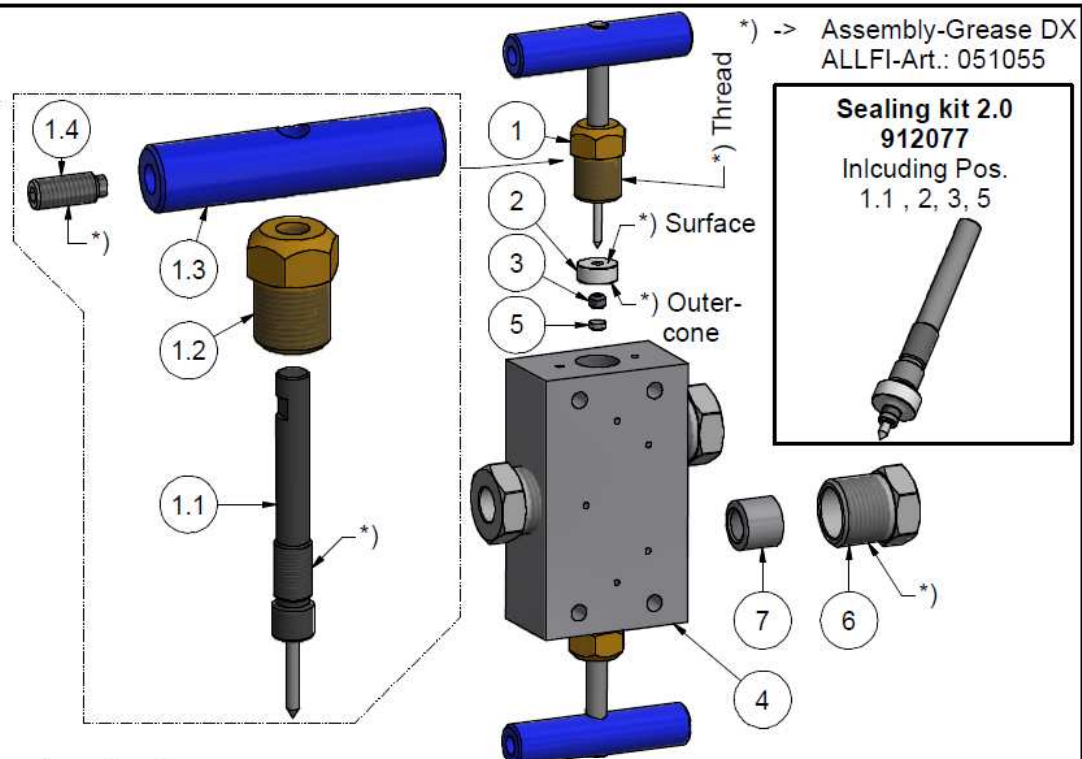
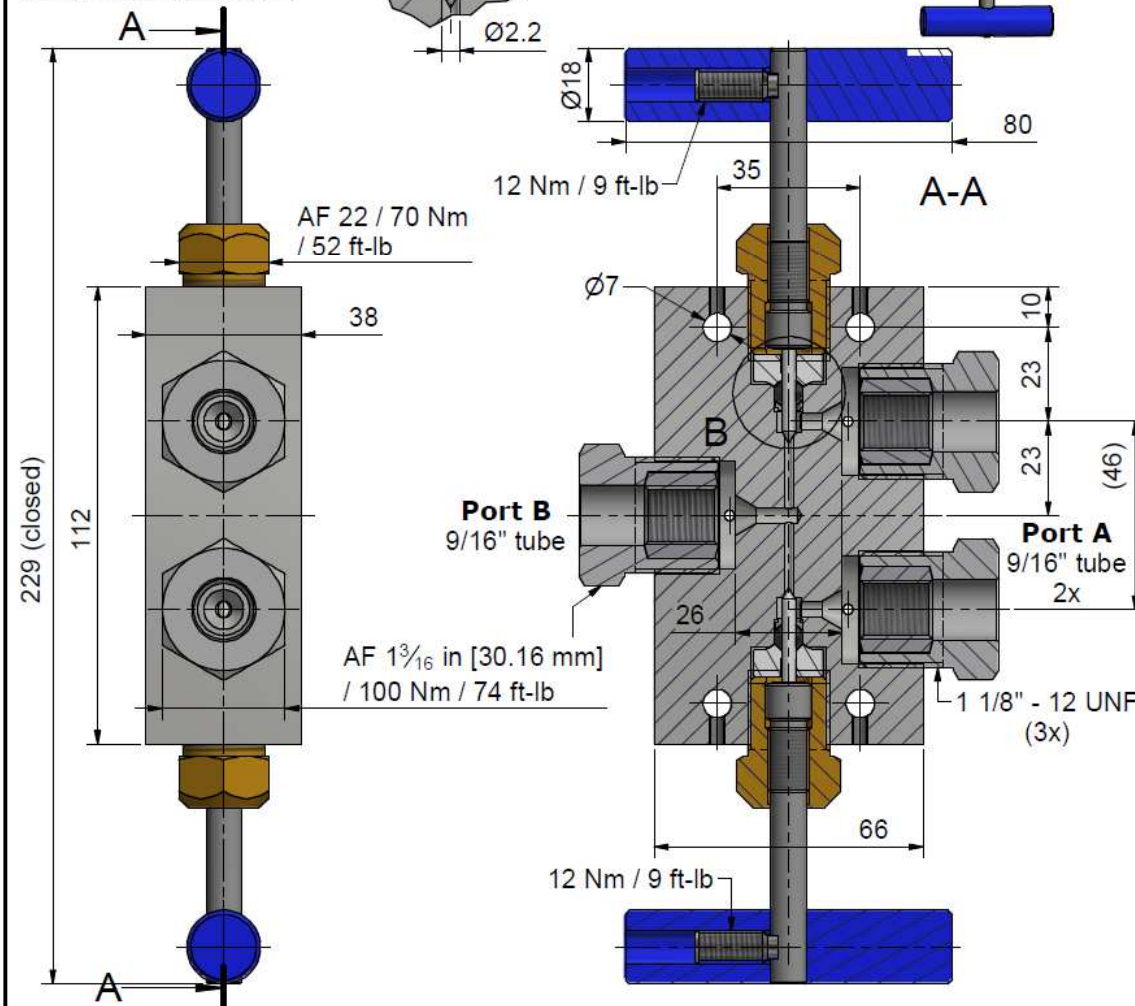
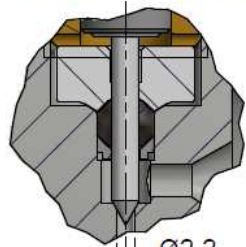

Item	Qty	Description	Part-Number	Comments	Weight
1	2	Spindle complete 2.0	910062		169.9 g
1.1	1	Needle with spindle 2.0	912059	Wear part	39.9 g
1.2	1	Spindle Nut 2.0	912058		75.1 g
1.3	1	Clamp Handle 2.0	912057		48.2 g
1.4	1	Screw	000044		6.7 g
2	2	Pressure plate 2.0	912053	Wear part	11.8 g
3	2	HP-Seal 2.0	912052	Wear part	1 g
4	1	Valve Body 3-Way 2-Stem 9/16" 2.0 Imp	912072-I	Wear part	1774.2 g
5	2	Conical disc 2.0	912062	Wear part	0.4 g
6	3	Gland Nut 9/16" Imp	709107		14.1 g
7	3	Collar 9/16"	719100		28.9 g

General tolerances ISO 2768-1 mK Designs and drawings created and produced by the contractor are the contractor's intellectual property and may only be used for the purposes of the order.

Amendment:		Replace for	912023-I
		Replaced by	-
		Drawn	08.09.2016 AM
		Checked	22.05.2017 RB
		Release	29.05.2017 BT
		Index-release	

Hand Valve 3-Way 2 Stem 9/16" 2.0 Imp

Scale: 3 : 4

Max 4150 bar / 60,000 psi
Hand Valve 2.0

911110-I

ALLFI AG - RIEDENMATT 1 - CH-6370 STANS
 PHONE +41(0)41-618 05 05 - TELEFAX +41(0)41-618 05 10
 E-MAIL: sales@allfi.com http://www.allfi.com

Index	Sheet- No.	2
	No. of sheets	2