

# Assembling - Maintenance

This drawing is appendix A of the installation and maintenance instruction "Hand valve 2.0".  
 Complete installation and maintenance instruction refer to QR-Code or:  
<https://www.allfi.com/en/services/downloads/product-manuals/>

- Pressure relief holes must not be covered or closed.

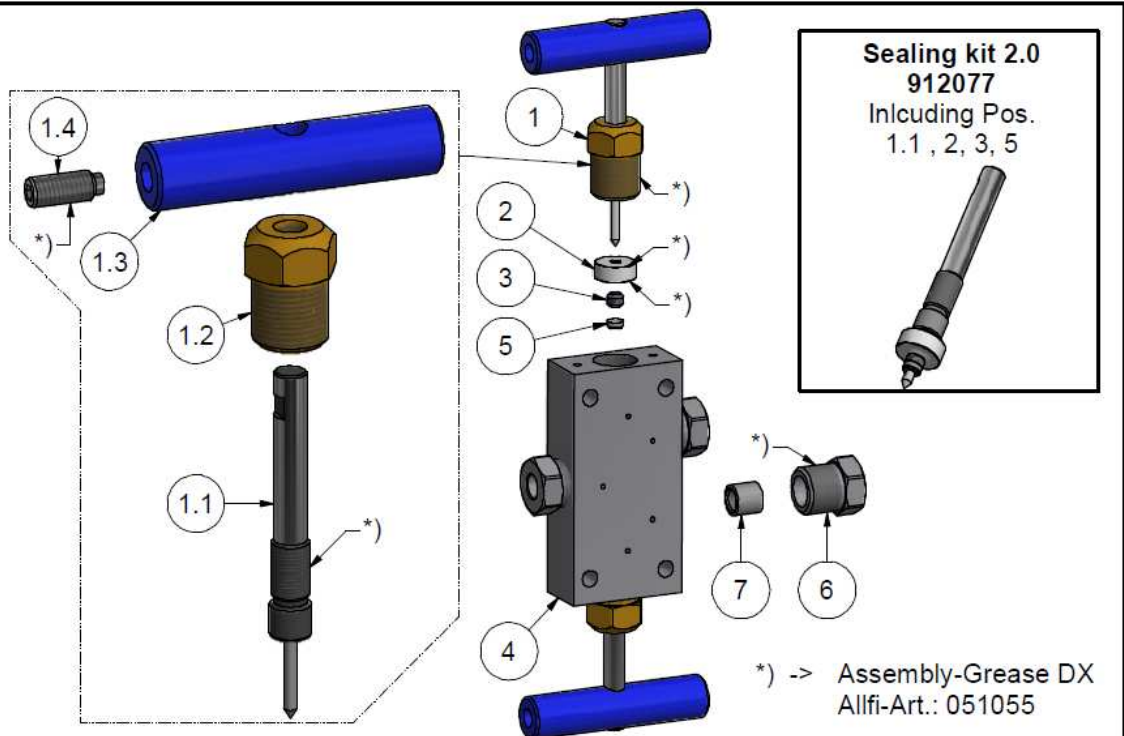
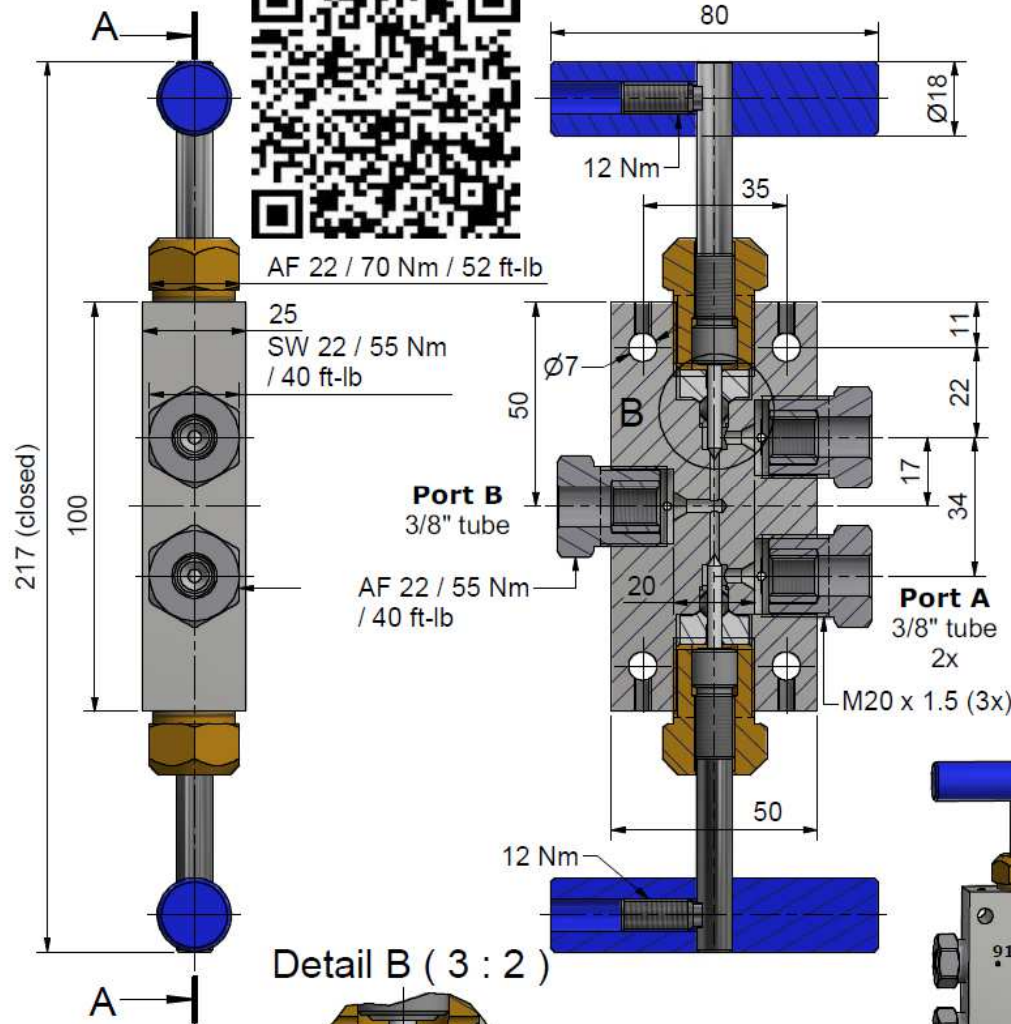

Item	Qty	Description	Part-Number	Comments	Weight
1	2	Spindle complete 2.0	910062		169.9 g
1.1	1	Needle with spindle 2.0	912059	Wear part	39.9 g
1.2	1	Spindle Nut 2.0	912058		75.1 g
1.3	1	Clamp Handle 2.0	912057		48.2 g
1.4	1	Screw	000044		6.7 g
2	2	Pressure plate 2.0	912053	Wear part	11.8 g
3	2	HP-Seal 2.0	912052	Wear part	1 g
4	1	Valve Body 2-Stem 3/8" 2.0	912068	Wear part	740.7 g
5	2	Conical disc 2.0	912062	Wear part	0.4 g
6	3	Gland Nut 3/8"	703800		48.1 g
7	3	Collar 3/8"	713800		6.8 g

General tolerances ISO 2768-1 mK. Designs and drawings created and produced by the contractor are the contractor's intellectual property and may only be used for the purposes of the order. Weight 1.27 kg

Amendment:	Replace for 912013, 911000
	Replaced by -
Drawn	01.09.2016 AM
Checked	02.05.2017 RB
Release	29.05.2017 BT
Index-release	

**Hand Valve 3-Way 2 Stem 3/8" 2.0**

Scale 3 : 4

Max 4150 bar / 60,000 psi  
Hand Valve 2.0

911010

Index -

Sheet- No. 2  
No. of sheets 2

**allfi**  
Components

ALLFI AG - RIEDENMATT 1 - CH-6370 STANS  
 PHONE +41(0)41-618 05 05  
 E-MAIL: sales@allfi.com

<http://www.allfi.com>