

# Assembling - Maintenance

This drawing is appendix A of the installation and maintenance instruction "Pneumatic Valve 2.0".  
Complete installation and maintenance instruction refer to QR-Code or:

<https://www.allfi.com/en/services/downloads/product-manuals/>

- Pressure relief holes must not be covered or closed.
- Pneumatic cylinder must not be pressurized during assembly & disassembly.

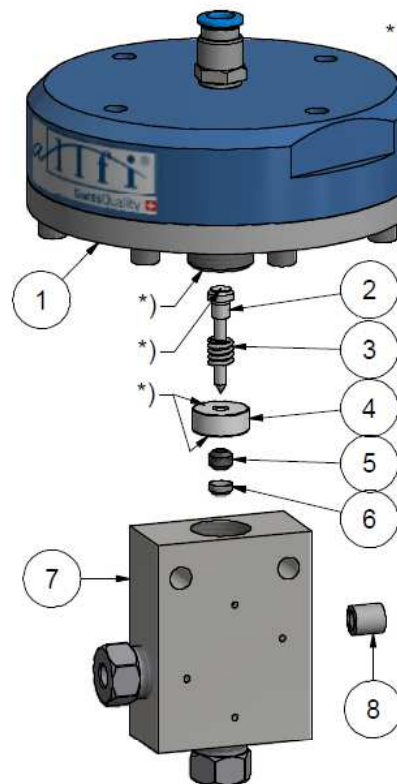

\*) -> Assembly-Grease DX  
Allfi-Art.: 051055

**Sealing kit 2.0**  
912050  
Including Pos.  
2,3,4,5,6

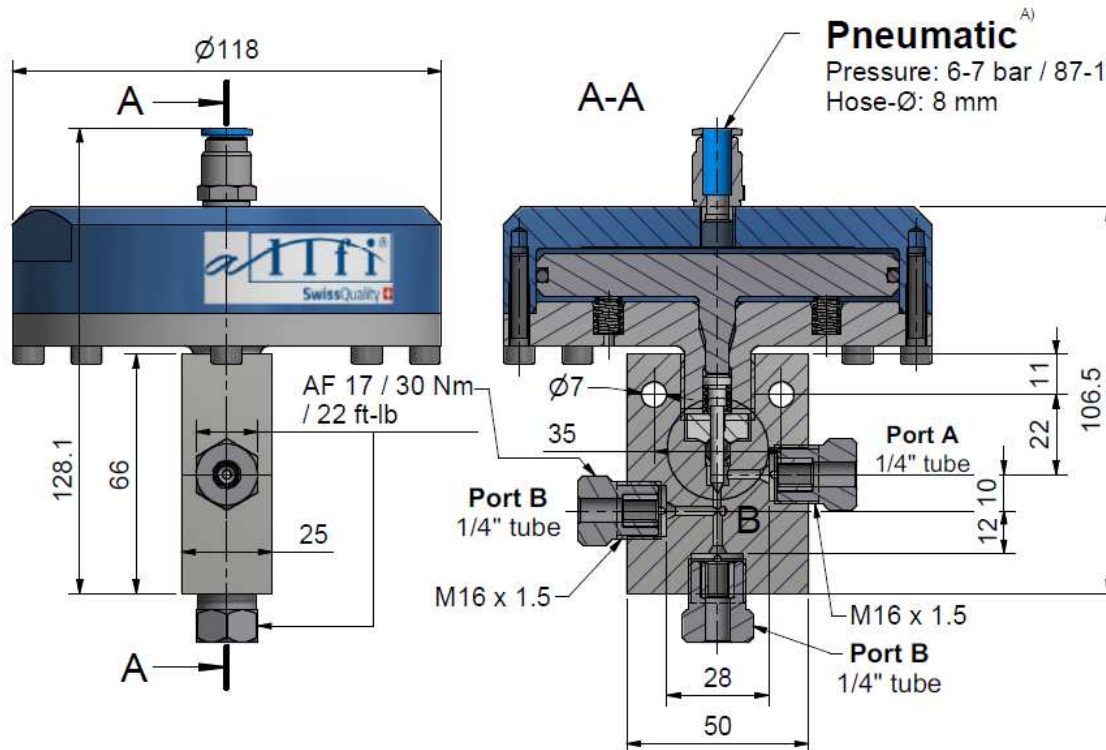

Detail B ( 2 : 1 )

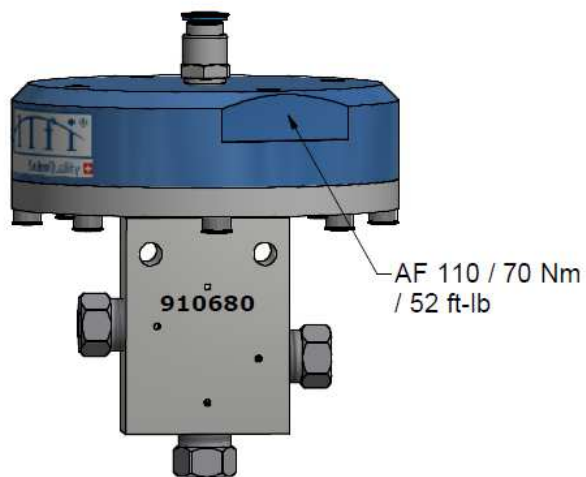
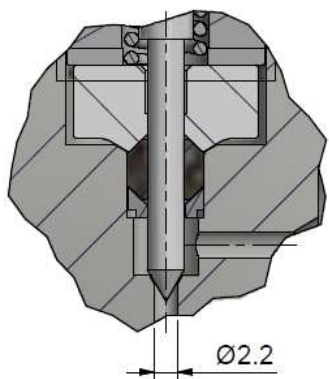

Item	Qty	Description	Part-Number	Comments	Weight
1	1	Pneumatic Cylinder 2.0 NO	912290		2120.3 g
2	1	Needle complete 2.0	912076	Wear part	2.2 g
3	1	Spring	021033		0.1 g
4	1	Pressure plate 2.0	912053	Wear part	11.8 g
5	1	HP-Seal 2.0	912052	Wear part	1 g
6	1	Conical disc 2.0	912062	Wear part	0.4 g
7	1	Valve Body 3-Way 1/4" 2.0	912064	Wear part	531.4 g
8	3	Collar 1/4"	711403		3.1 g
9	3	Gland Nut 1/4"	701403		29.1 g

General tolerances ISO 2768-1 m Designs and drawings created and produced by the contractor are the contractor's intellectual property and may only be used for the purposes of the order. Weight 2.76 kg

Amendment: A) 0080, Air pressure redefined, 27.10.2021 AM	Replace for -	
	Replaced by -	
Drawn	23.03.2017	AM
Checked	05.12.2017	RB
Release	05.12.2017	RB
Index-release	28.10.2021	RB

**Pneum. Valve 3-Way 1/4" NO 2.0**

Scale 2 : 3

**allfi Components**

ALLFI AG - RIEDENMATT 1 - CH-6370 STANS  
PHONE +41(0)41-618 05 05 - TELEFAX +41(0)41-618 05 10  
E-MAIL: sales@allfi.com http://www.allfi.com

Max. 4150 bar / 60,000 psi  
Normally open

**910680**

Index	Sheet- No.	2
	No. of sheets	2