

Assembling - Maintenance

This drawing is appendix A of the installation and maintenance instruction "Pneumatic Valve 2.0".
 Complete installation and maintenance instruction refer to QR-Code or:
<https://www.allfi.com/en/services/downloads/product-manuals/>

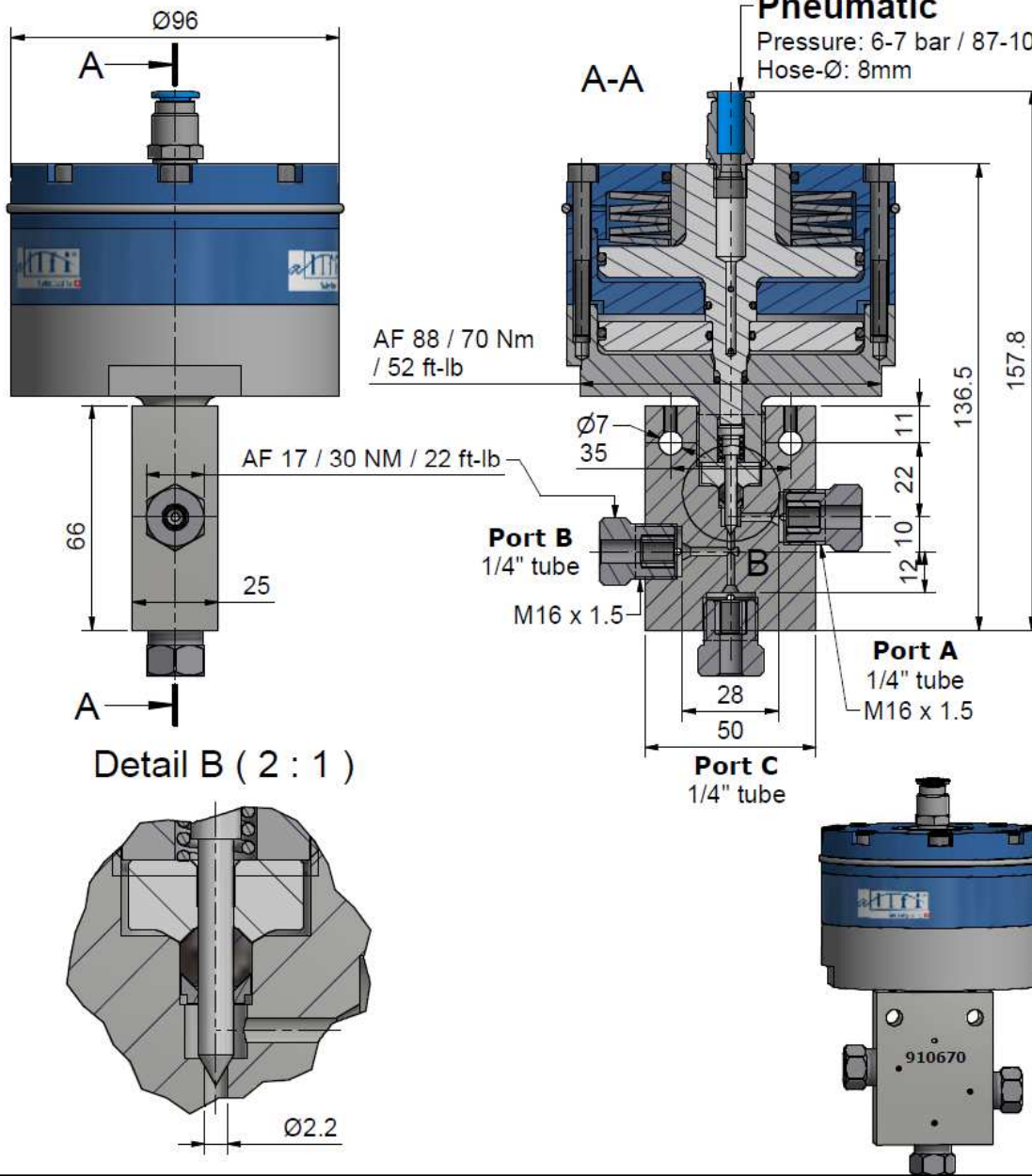

- Pressure relief holes must not be covered or closed.



*) -> Montage-Paste DX
 Allfi-Art.: 051055

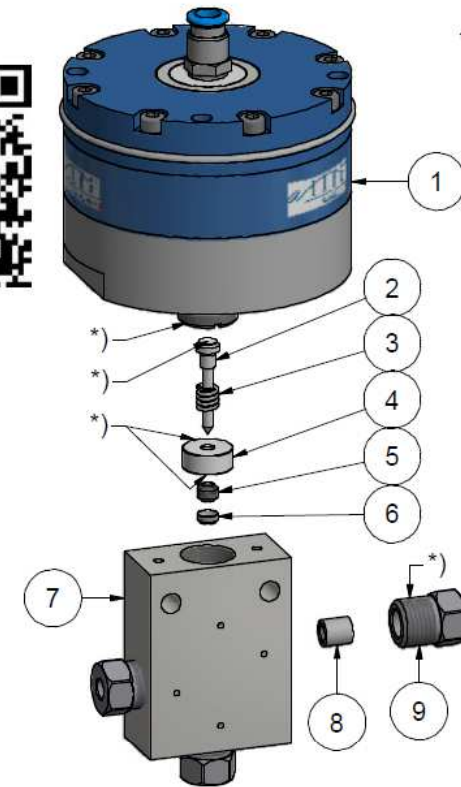

Item	Qty	Description	Part-Number	Comments	Weight
1	1	Pneumatic cylinder 2.0 NC	912190		2293.9 g
2	1	Needle complete 2.0	912076	Wear part	2.2 g
3	1	Spring	021033		0.1 g
4	1	Pressure plate 2.0	912053	Wear part	11.8 g
5	1	HP-Seal 2.0	912052	Wear part	1 g
6	1	Conical disc 2.0	912062	Wear part	0.4 g
7	1	Valve Body 3-Way 1/4" 2.0	912064	Wear part	530.4 g
8	3	Collar 1/4"	711403		3.1 g
9	3	Gland Nut 1/4"	701403		29.1 g

General tolerances ISO 2768-1 m Designs and drawings created and produced by the contractor are the contractor's intellectual property and may only be used for the purposes of the order.

Amendment:	Replace for	-
	Replaced by	-
	Drawn	24.03.2017 AM
	Checked	14.12.2017 RB
	Release	14.12.2017 RB
	Index-release	

Pneum. Valve 3-Way 1/4" NC 2.0

Scale
2 : 3

allfi
 Components
 ALLFI AG - RIEDENMATT 1 - CH-6370 STANS
 PHONE +41(0)41-618 05 05 - TELEFAX +41(0)41-618 05 10
 E-MAIL: sales@allfi.com http://www.allfi.com

Max 4150 bar / 60,000 psi
 Normally closed
910670
 Index - Sheet-No. 2
 No. of sheets 2