

Assembling - Maintenance

This drawing is appendix A of the installation and maintenance instruction "Pneumatic Valve 2.0".
Complete installation and maintenance instruction refer to QR-Code or:

<https://www.allfi.com/en/services/downloads/product-manuals/>

- Pressure relief holes must not be covered or closed.
- Pneumatic cylinder must not be pressurized during assembly & disassembly.

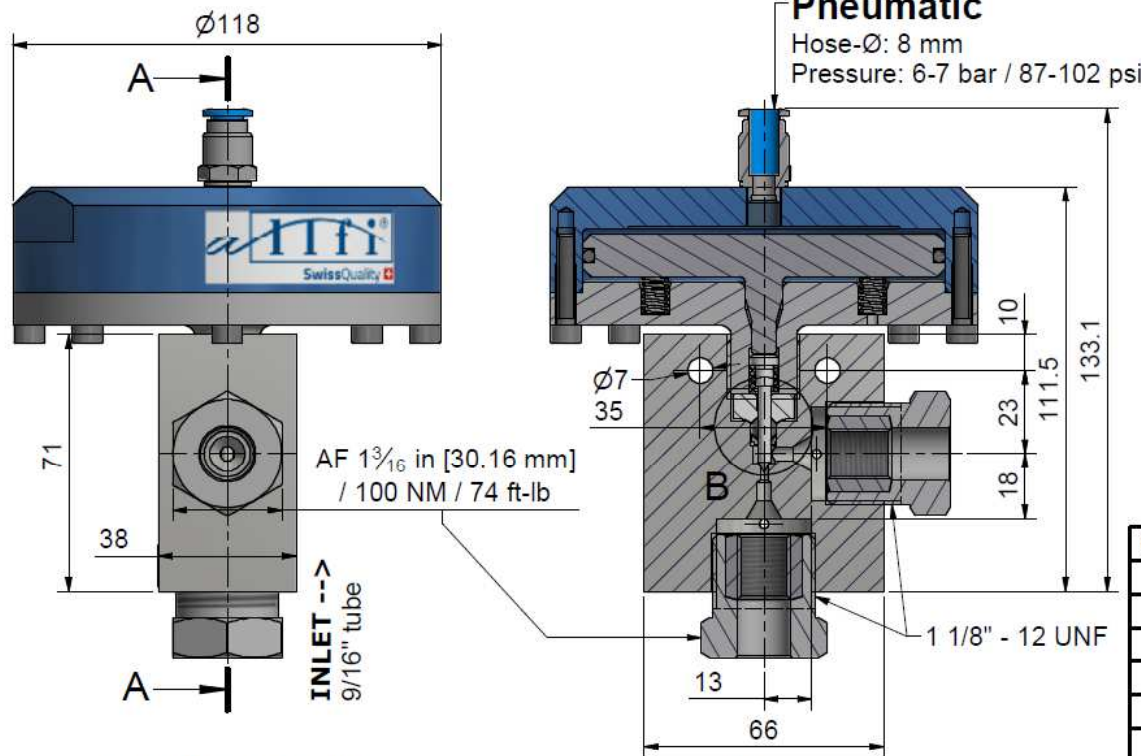

Detail B (2 : 1)

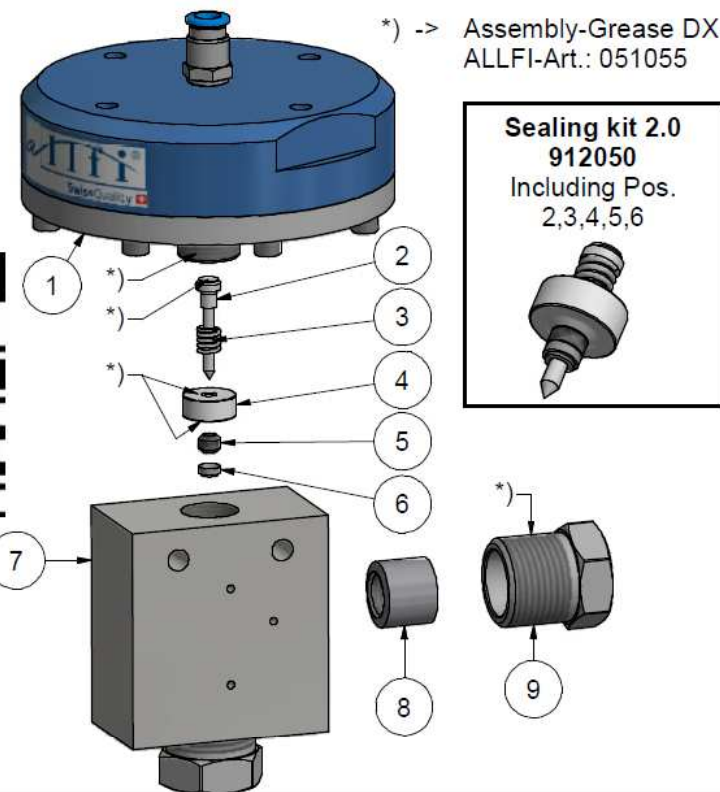
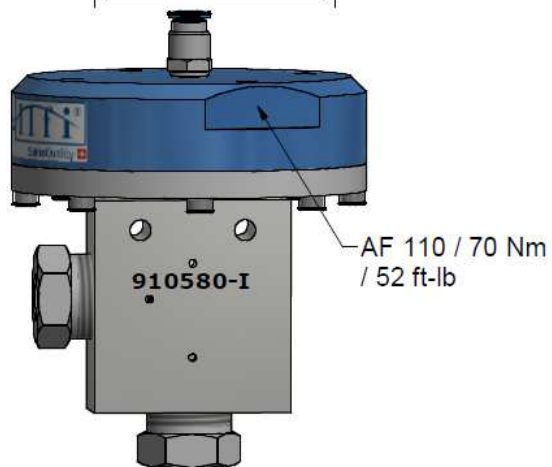
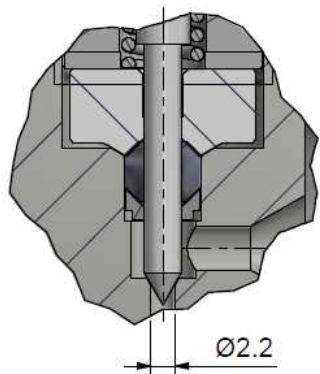

Item	Qty	Description	Part-Number	Comments	Weight
1	1	Pneumatic Cylinder 2.0 NO	912290		2120.3 g
2	1	Needle complete 2.0	912076	Wear part	2.2 g
3	1	Spring	021033		0.1 g
4	1	Pressure plate 2.0	912053	Wear part	11.8 g
5	1	HP-Seal 2.0	912052	Wear part	1 g
6	1	Conical disc 2.0	912062	Wear part	0.4 g
7	1	Valve body angle 9/16" 2.0 Imp	912074-I	Wear part	146 g
8	2	Collar 9/16"	719100		28.9 g
9	2	Gland Nut 9/16" Imp	709107		14.1 g

General tolerances ISO 2768-1 m Designs and drawings created and produced by the contractor are the contractor's intellectual property and may only be used for the purposes of the order. Weight -

Amendment:	Replace for -
	Replaced by -
	Drawn by 23.03.2017 AM
Pneum. Valve 2-Way Angle 9/16" NO 2.0 Imp	Scale 2 : 3
	Checked 21.02.2022 BT
	Release 21.02.2022 BT
	Index-release

 ALLFI AG - RIEDENMATT 1 - CH-6370 STANS PHONE +41(0)41-618 05 05 E-MAIL: sales@allfi.com	Max 4150 bar / 60,000 psi Normally open	Index	Sheet-	2
			No. of sheets	2
910580-I				
http://www.allfi.com				