

# Assembling - Maintenance

This drawing is appendix A of the installation and maintenance instruction "Pneumatic Valve 2.0".  
 Complete installation and maintenance instruction refer to QR-Code or:  
<https://www.allfi.com/en/services/downloads/product-manuals/>

- Pressure relief holes must not be covered or closed.



Detail B

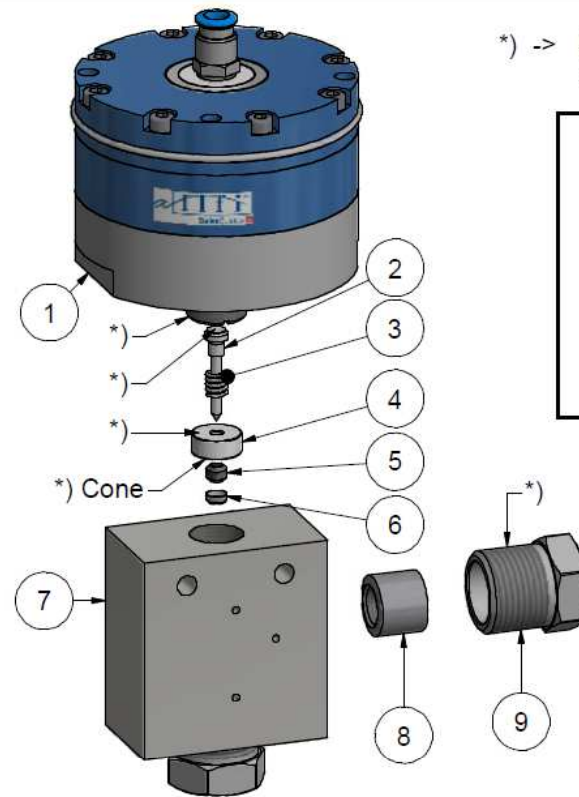
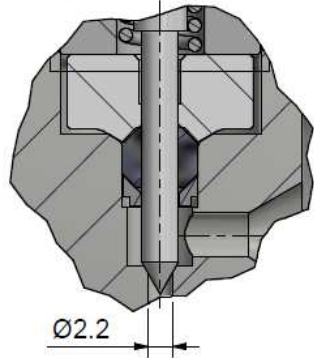

\*) -> Assembly-Grease DX  
 Allfi-Art.: 051055



## Pneumatic

Pressure: 6-7 bar / 87-102 psi  
 Hose-Ø: 8 mm

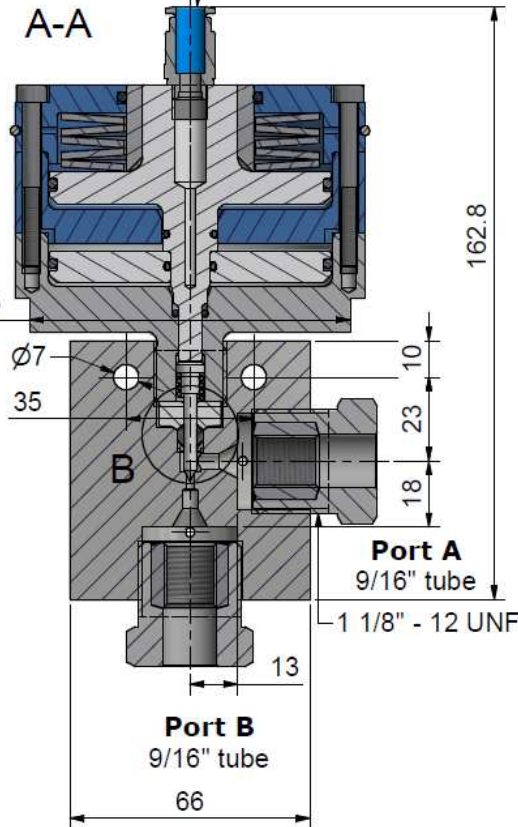
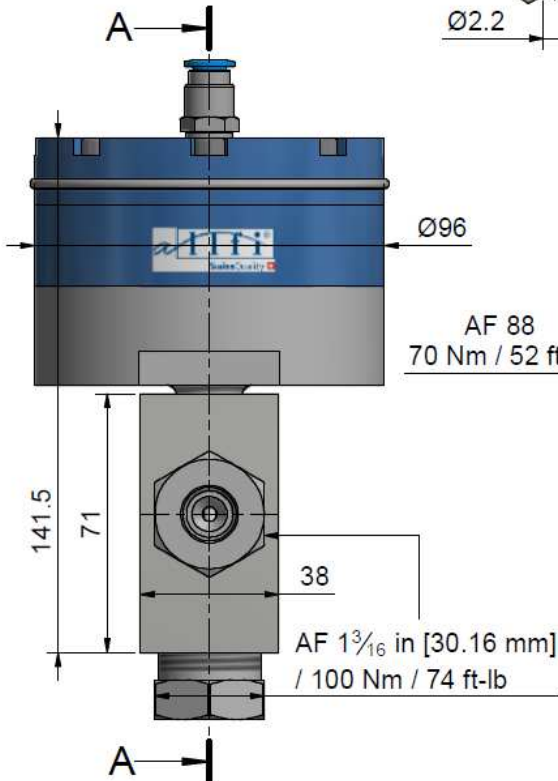

Item	Qty	Description	Part-Number	Characteristics	Weight
1	1	Pneumatic cylinder 2.0 NC	912190		2293.9 g
2	1	Needle complete 2.0	912076	Wear part	2.2 g
3	1	Spring	021033		0.1 g
4	1	Pressure plate 2.0	912053	Wear part	11.8 g
5	1	HP-Seal 2.0	912052	Wear part	1 g
6	1	Conical disc 2.0	912062	Wear part	0.4 g
7	1	Valve body angle 9/16" 2.0 Imp	912074-I	Wear part	146 g
8	2	Collar 9/16"	719100		28.9 g
9	2	Gland Nut 9/16" Imp	709107		14.1 g

General tolerances ISO 2768-1 m Designs and drawings created and produced by the contractor are the contractor's intellectual property and may only be used for the purposes of the order. Weight 2,54 kg

Amendment:	Replace for	-
	Replaced by	-
Pneum. Valve 2-Way Angle 9/16" NC 2.0 Imp	Drawn	17.03.2017 AM
	Checked	28.02.2018 RB
	Release	28.02.2018 RB
	Index-release	

Scale 2 : 3

Max 4150 bar / 60,000 psi  
 Normally closed

**910570-I**

Index	-	Sheet-No.	2
		No. of sheets	2



ALLFI AG - RIEDENMATT 1 - CH-6370 STANS  
 PHONE +41(0)41-618 05 05  
 E-MAIL: sales@allfi.com <http://www.allfi.com>