

# Assembling - Maintenance

This drawing is appendix A of the installation and maintenance instruction "Pneumatic Valve 2.0".  
 Complete installation and maintenance instruction refer to QR-Code or:  
<https://www.allfi.com/en/services/downloads/product-manuals/>

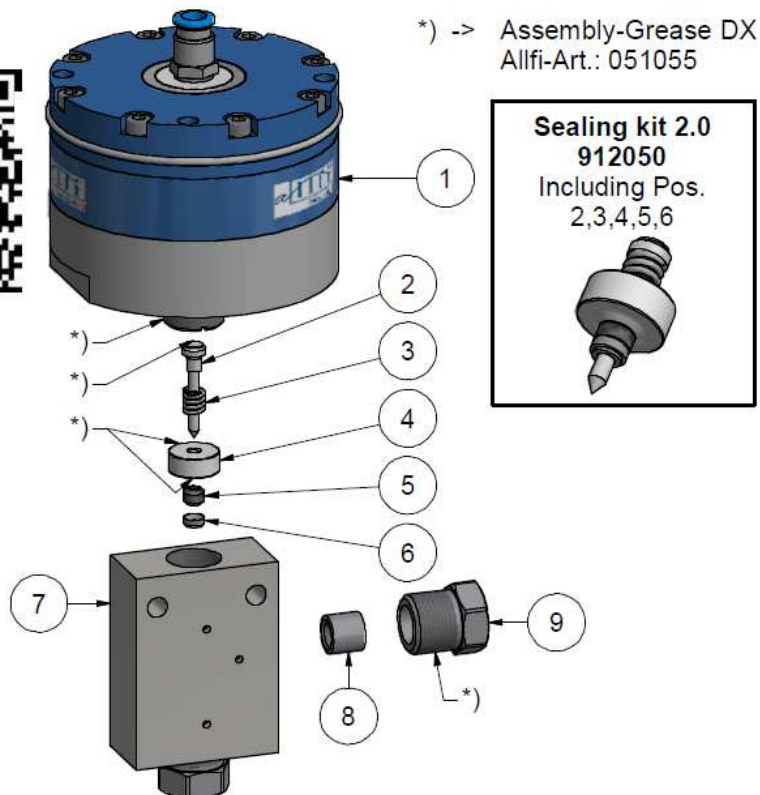

- Pressure relief holes must not be covered or closed.

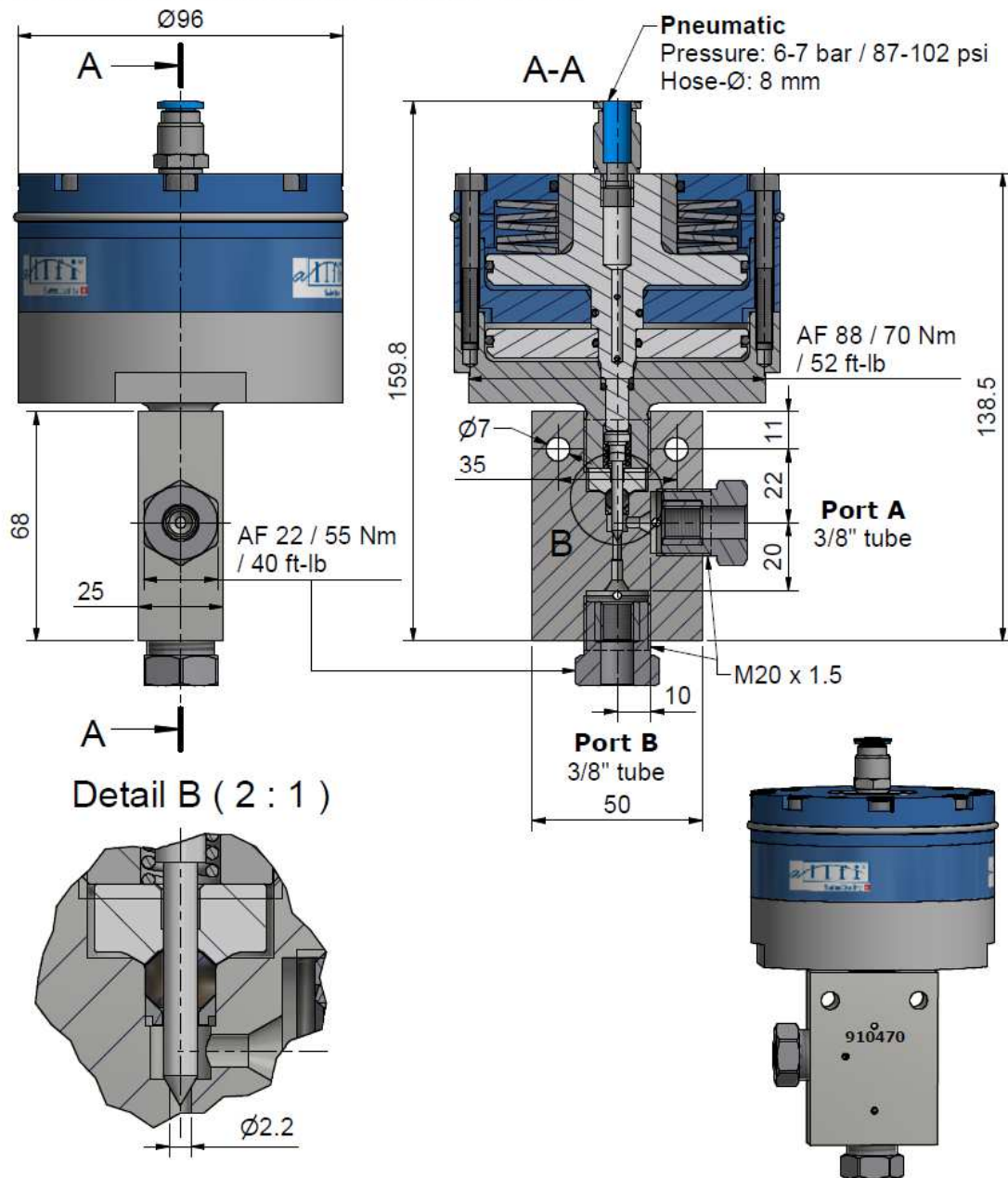

Item	Qty	Description	Part-Number	Comments	Weight
1	1	Pneumatic cylinder 2.0 NC	912190		2293.9 g
2	1	Needle complete 2.0	912076	Wear part	2.2 g
3	1	Spring	021033		0.1 g
4	1	Pressure plate 2.0	912053	Wear part	11.8 g
5	1	HP-Seal 2.0	912052	Wear part	1 g
6	1	Conical disc 2.0	912062	Wear part	0.4 g
7	1	Valve Body angle 3/8" 2.0	912066	Wear part	530.7 g
8	2	Collar 3/8"	713800		6.8 g
9	2	Gland Nut 3/8"	703800		48.1 g

General tolerances ISO 2768-1 m. Designs and drawings created and produced by the contractor are the contractor's intellectual property and may only be used for the purposes of the order.

Amendment:	Replace for 916600
	Replaced by -
	Drawn 24.03.2017 AM

Pneum. Valve 2-Way Angle 3/8" NC 2.0	Scale 2 : 3	Checked 30.01.2018 RB
		Release 30.01.2018 RB
		Index-release

Max 4150 bar / 60,000 psi  
Normally closed

 ALLFI AG - RIEDENMATT 1 - CH-6370 STANS PHONE +41(0)41-618 05 05 - TELEFAX +41(0)41-618 05 10 E-MAIL: sales@allfi.com http://www.allfi.com	910470	Index	-	Sheet- No.	2
		No. of sheets	2		