

Assembling - Maintenance

This drawing is appendix A of the installation and maintenance instruction "Pneumatic Valve 2.0". Complete installation and maintenance instruction refer to QR-Code or: <https://www.allfi.com/en/services/downloads/product-manuals/>

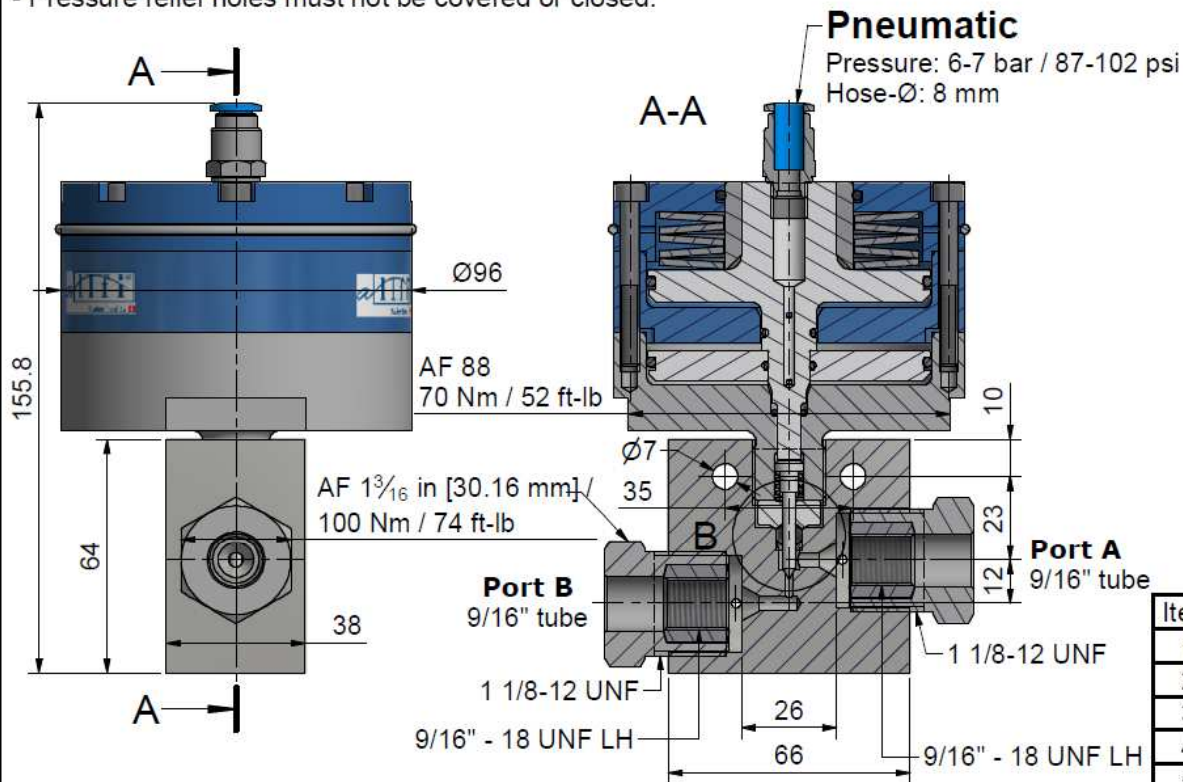

- Pressure relief holes must not be covered or closed.



Detail B (2 : 1)

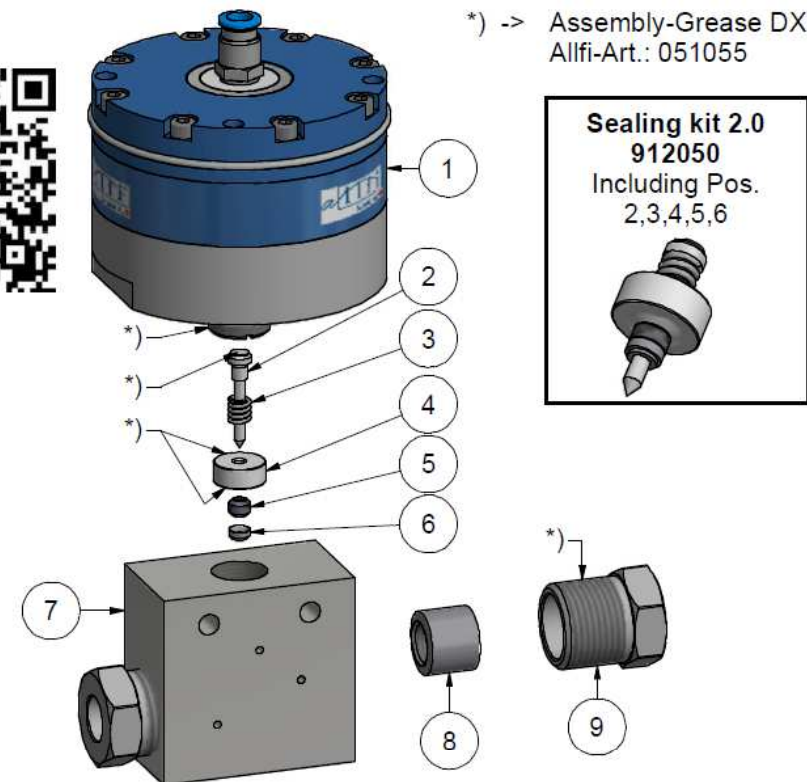
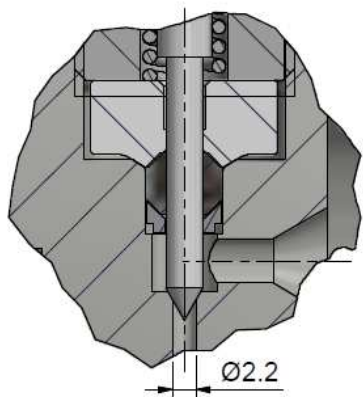

Item	Qty	Description	Part-Number	Comments	Weight
1	1	Pneumatic cylinder 2.0 NC	912190		2293.9 g
2	1	Needle complete 2.0	912076	Wear part	2.2 g
3	1	Spring	021033		0.1 g
4	1	Pressure plate 2.0	912053	Wear part	11.8 g
5	1	HP-Seal 2.0	912052	Wear part	1 g
6	1	Conical disc 2.0	912062	Wear part	0.4 g
7	1	Valve Body straight 9/16" 2.0 Imp	912069-I	Wear part	1000.9 g
8	2	Collar 9/16"	719100		28.9 g
9	2	Gland Nut 9/16" Imp	709107		14.1 g

General tolerances ISO 2768-1 m		Designs and drawings created and produced by the contractor are the contractor's intellectual property and may only be used for the purposes of the order.		Weight 3.40 kg
Amendment:			Replace for:	-
			Replaced by:	-
		Drawn	06.04.2017	AM
		Checked	26.09.2017	RB
		Release	17.01.2018	RB
		Index-release		

Pneum. Valve 2-Way Straight 9/16" NC 2.0 Imp

Scale
2 : 3

Max 4150 bar / 60,000 psi
Normally closed

910270-I

ALLFI AG - RIEDENMATT 1 - CH-6370 STANS
PHONE +41(0)41-618 05 05 - TELEFAX +41(0)41-618 05 10
E-MAIL: sales@allfi.com http://www.allfi.com

Index	Sheet- No.	2
	No. of sheets	2