

Assembling - Maintenance

This drawing is appendix A of the installation and maintenance instruction "Pneumatic Valve 2.0".
 Complete installation and maintenance instruction refer to QR-Code or:
<https://www.allfi.com/en/services/downloads/product-manuals/>



- Pressure relief holes must not be covered or closed.
- Pneumatic cylinder must not be pressurized during assembly & disassembly.

*) -> Assembly-Grease DX
 Allfi-Art.: 051055

Sealing kit 2.0
 912050
 Including Pos.
 2,3,4,5,6

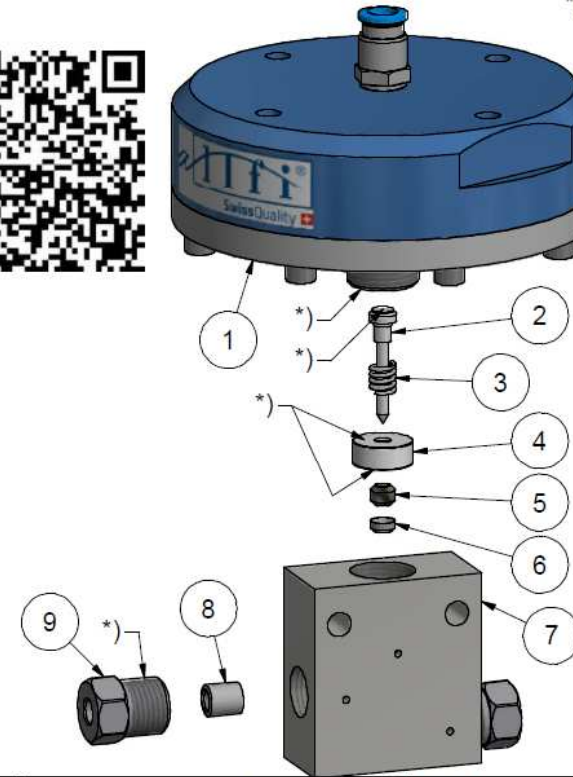
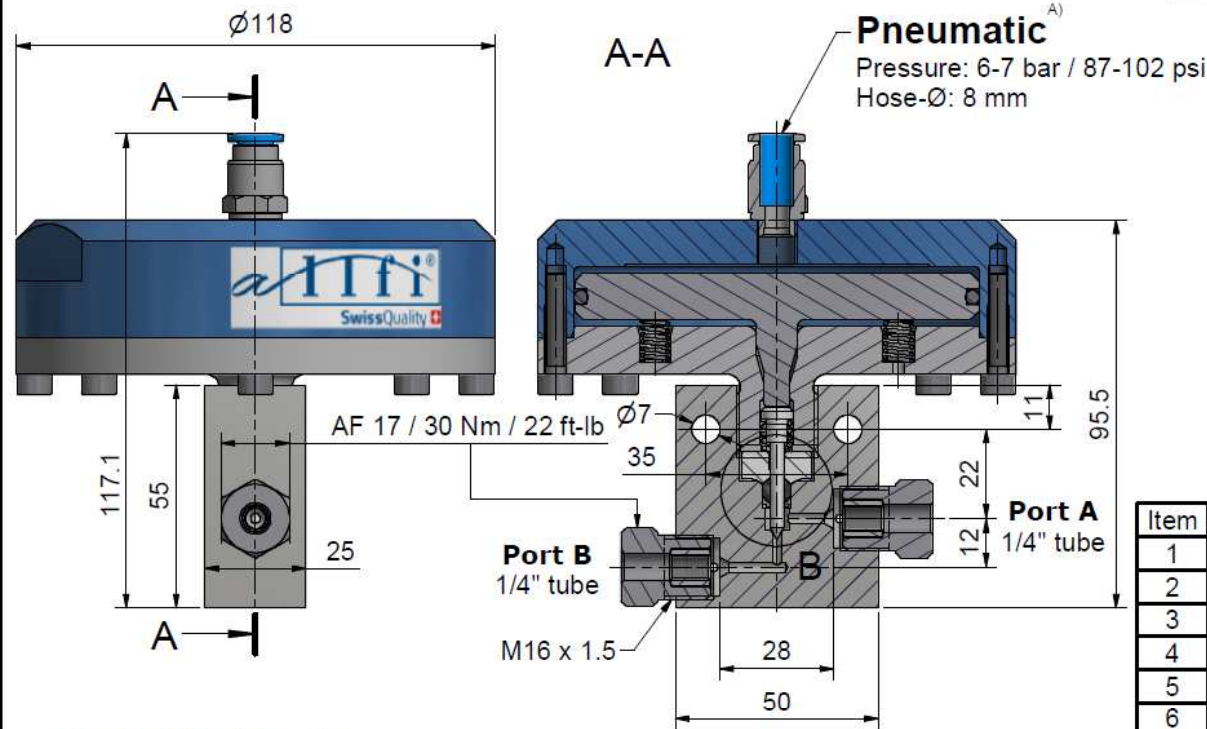

Item	Qty	Description	Part-Number	Comments	Weight
1	1	Pneumatic Cylinder 2.0 NO	912290		2120.3 g
2	1	Needle complete 2.0	912076	Wear part	2.2 g
3	1	Spring	021033		0.1 g
4	1	Pressure plate 2.0	912053	Wear part	11.8 g
5	1	HP-Seal 2.0	912052	Wear part	1 g
6	1	Conical disc 2.0	912062	Wear part	0.4 g
7	1	Valve Body straight 1/4\" 2.0	912051	Wear part	438.8 g
8	2	Collar 1/4\"	711403		3.1 g
9	2	Gland Nut 1/4\"	701403		29.1 g

General tolerances ISO 2768-1 m		Designs and drawings created and produced by the contractor are the contractor's intellectual property and may only be used for the purposes of the order.		Weight 2.64 kg
Amendment: A) 0080, Air pressure redefined, 27.10.2021 AM		Replace for	915000	
		Replaced by	-	
		Drawn	07.03.2017	AM
		Checked	05.12.2017	RB
		Release	05.12.2017	RB
		Index-release	27.10.2021	RB

Pneum. Valve 2-Way Straight 1/4\" NO 2.0		Scale 3 : 4	Max 4150 bar / 60,000 psi Normally open	
		910080		Index A
ALLFI AG - RIEDENMATT 1 - CH-6370 STANS PHONE +41(0)41-618 05 05 - TELEFAX +41(0)41-618 05 10 E-MAIL: sales@allfi.com		http://www.allfi.com		Sheet- No. 2 No. of sheets 2