

Assembling - Maintenance

This drawing is appendix A of the installation and maintenance instruction "Pneumatic Valve 2.0".
 Complete installation and maintenance instruction refer to QR-Code or:
<https://www.allfi.com/en/services/downloads/product-manuals/>

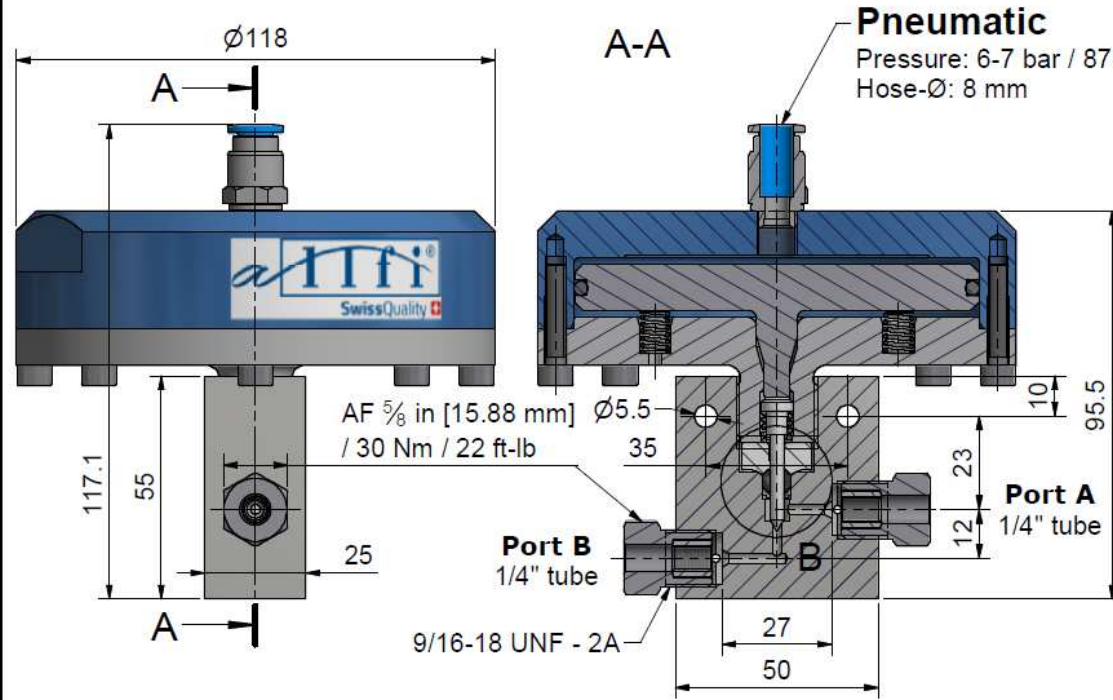

- Pressure relief holes must not be covered or closed.
- Pneumatic cylinder must not be pressurized during assembly & disassembly.



Detail B (2 : 1)

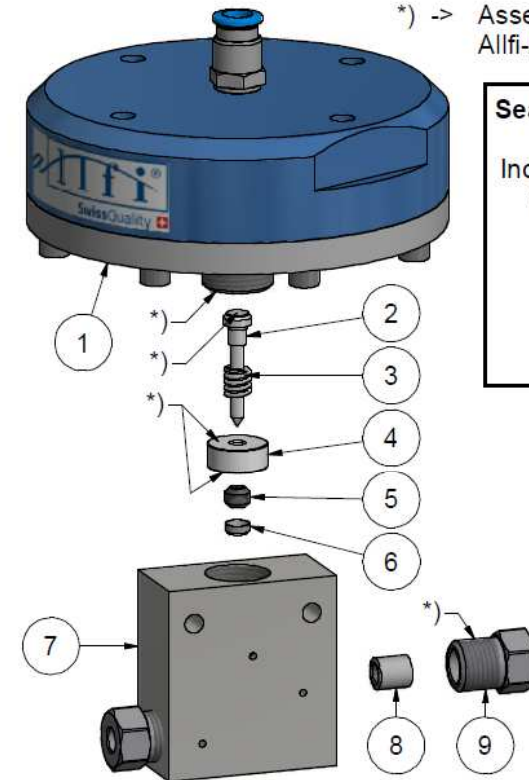
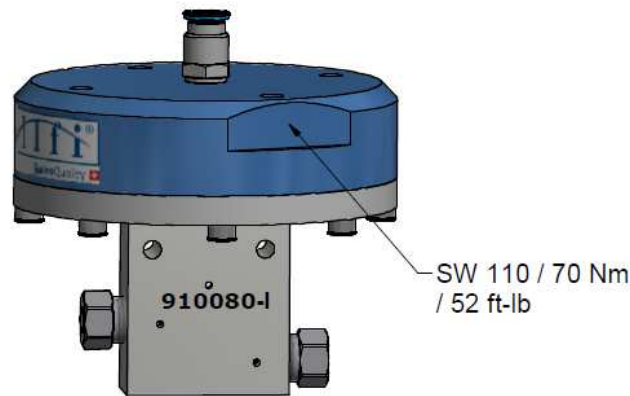
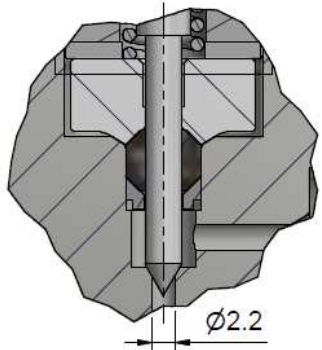

*) -> Assembly-Grease DX
 Allfi-Art.: 051055

Sealing kit 2.0
912050
 Including Pos.
 2,3,4,5,6



Item	Qty	Description	Part-Number	Comments	Weight
1	1	Pneumatic Cylinder 2.0 NO	912290		2120.3 g
2	1	Needle complete 2.0	912076	Wear part	2.2 g
3	1	Spring	021033		0.1 g
4	1	Pressure plate 2.0	912053	Wear part	11.8 g
5	1	HP-Seal 2.0	912052	Wear part	1 g
6	1	Conical disc 2.0	912062	Wear part	0.4 g
7	1	Valve Body straight 1/4" 2.0 Imp	912051-I	Wear part	449.5 g
9	2	Gland Nut 1/4" Imp	701407		22.8 g
8	2	Collar 1/4"	711403		3.1 g

General tolerances ISO 2768-1 m Designs and drawings created and produced by the contractor are the contractor's intellectual property and may only be used for the purposes of the order.

Amendment:	Replace for	915000-I
	Replaced by	-
	Drawn	22.06.2023 AM
	Checked	28.06.2023 BT
	Release	28.06.2023 BT
	Index-release	

Pneum. Valve 2-Way Straight 1/4" NO 2.0 Imp

Scale
 3 : 4

allfi
 Components
 ALLFI AG - RIEDENMATT 1 - CH-6370 STANS
 PHONE +41(0)41-618 05 05 - TELEFAX +41(0)41-618 05 10
 E-MAIL: sales@allfi.com http://www.allfi.com

Max 4150 bar / 60,000 psi
 Normally open
910080-I
 Index: -
 Sheet-No. 2
 No. of sheets 2