

Assembling - Maintenance

This drawing is appendix A of the installation and maintenance instruction "Cutting head type X 3.0".
The complete installation and maintenance instruction is hosted at: www.allfi.com

- Pneumatic cylinder must be pressurised with air during assembling and disassembling of valve case and collimation tube.
- Stroke adjustment: Stroke 0.6 - 0.8 mm / 0.0235 - 0.0315", adjustment range +/- 1 revolution.
(Attention: Thread of cylinder cover must not be visible)
- Function test with several open and closed cycles.
- After finishing maintenance flush the complete cutting head without nozzle at < 500 bar / 7,200 psi.
- Pressure relief holes must not be covered or closed.

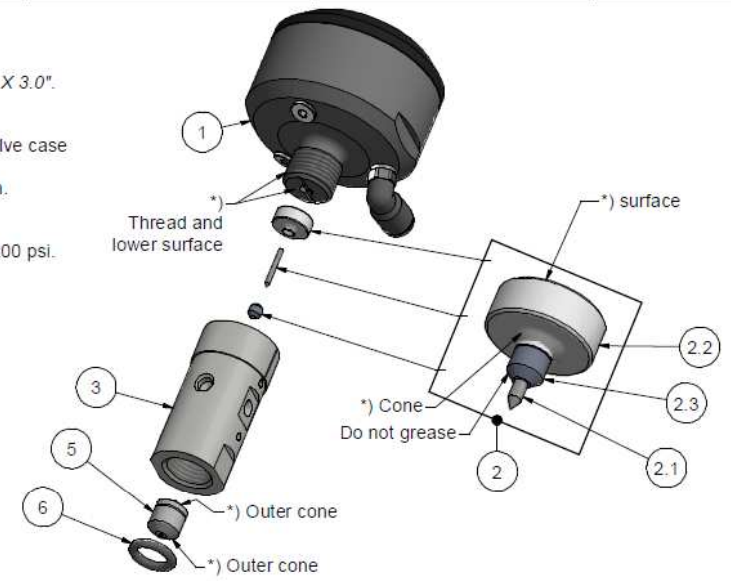
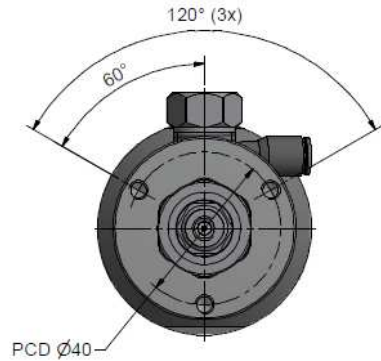

*) -> Assembly-Grease DX
ALLFI-Art.: 051055

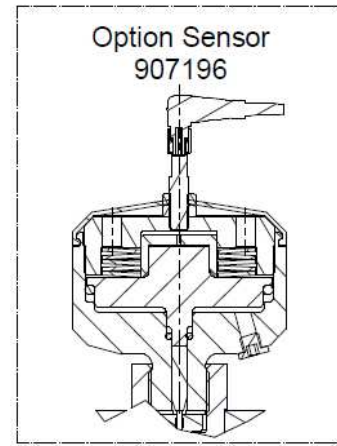
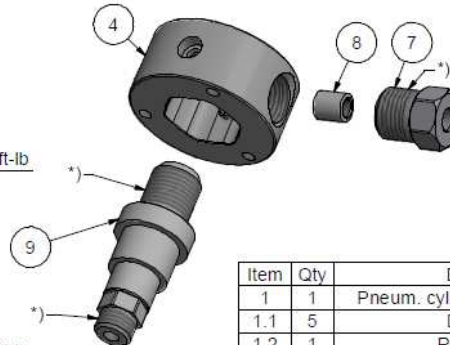
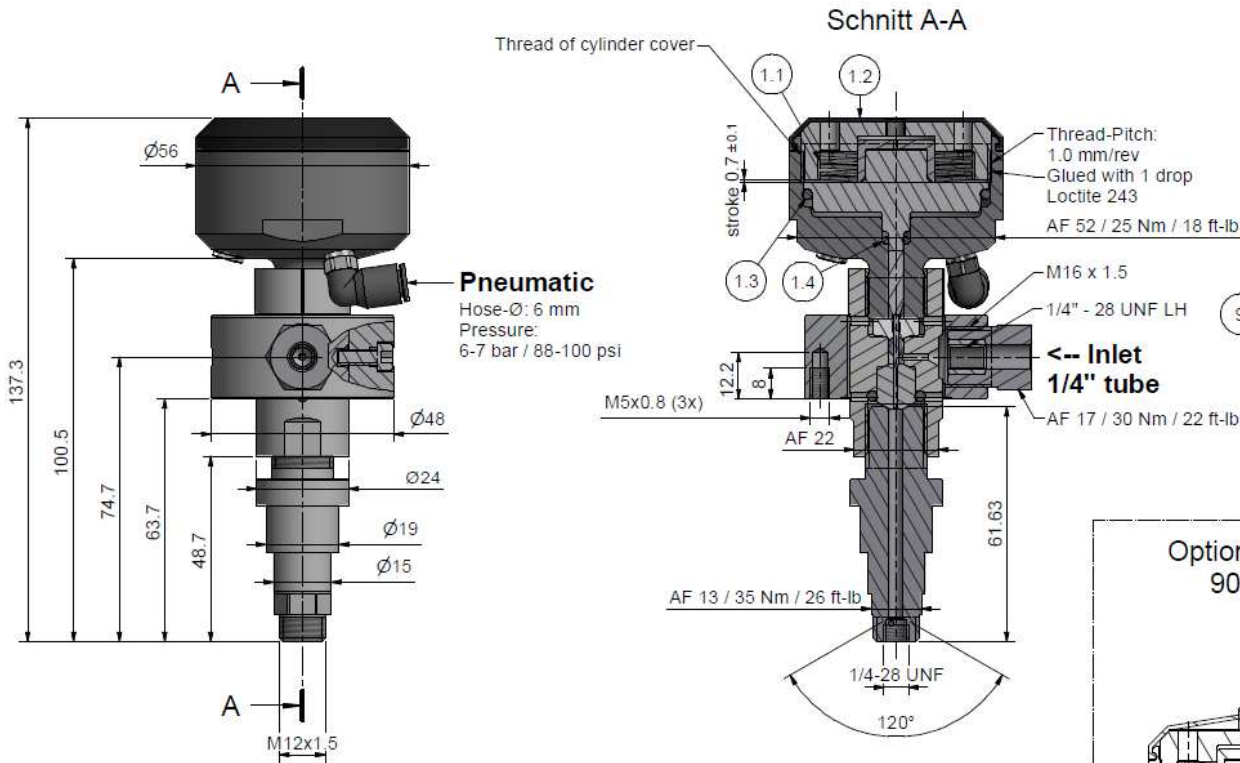

Item	Qty	Description	Part-Number	Comments	Weight
1	1	Pneum. cylinder type X 2.0 & 3.0	907190		251.3 g
1.1	5	Disc spring	021028	Wear part	7.4 g
1.2	1	Rubber cover	907192	Wear part	3.3 g
1.3	1	O-Ring D=44.12 x 2.62	010131	Wear part	0.8 g
1.4	1	O-Ring D=3.68 x 1.78	010130	Wear part	0 g
2	1	Seal kit Typ X 2.0	907130	Wear part	4.3 g
2.1	1	Valve Needle type X 2.0 & 3.0	907116		0.2 g
2.2	1	Pressure plate type X 2.0	907118		4 g
2.3	1	HP-seal type X 2.0 & 3.0	907117		0.1 g
3	1	Valve case type X 2.0	907110	Wear part	123.5 g
4	1	Coupling ring X 2.0 & 3.0	907174		202.2 g
5	1	Valve seat	907214	Wear part	6.1 g
6	1	O-Ring D=9.92 x 2.62	010121		0.2 g
7	1	Gland Nut 1/4"	701403		29.1 g
8	1	Collar 1/4"	711403		3.1 g
9	1	Kollimationsrohr L=61.63	970103	Wear part	102.1 g

General tolerances ISO 2768-1 mK		Designs and drawings created and produced by the contractor are the contractor's intellectual property and may only be used for the purposes of the order.		Weight
Amendment:		Replace for	-	
		Replaced by	-	
		Drawn	09.05.2022	AM
		Checked	21.09.2022	GB
		Release	21.09.2022	GB
		Index-release		

Cutting Head Type X 2.0 PWJ SP29

Scale: 1 : 1

Max. 4150 bar / 60,000 psi

907155

ALLFI AG - RIEDENMATT 1 - CH-8370 STANS
PHONE +41(0)41-818 05 05
E-MAIL: sales@allfi.com <http://www.allfi.com>

Index	Sheet No.	2
	No. of sheets	2